

SYSTEM 40[®] MOTORISED ROLLER SYSTEM LITHIUM RE-CHARGEABLE BATTERY 1800 SERIES

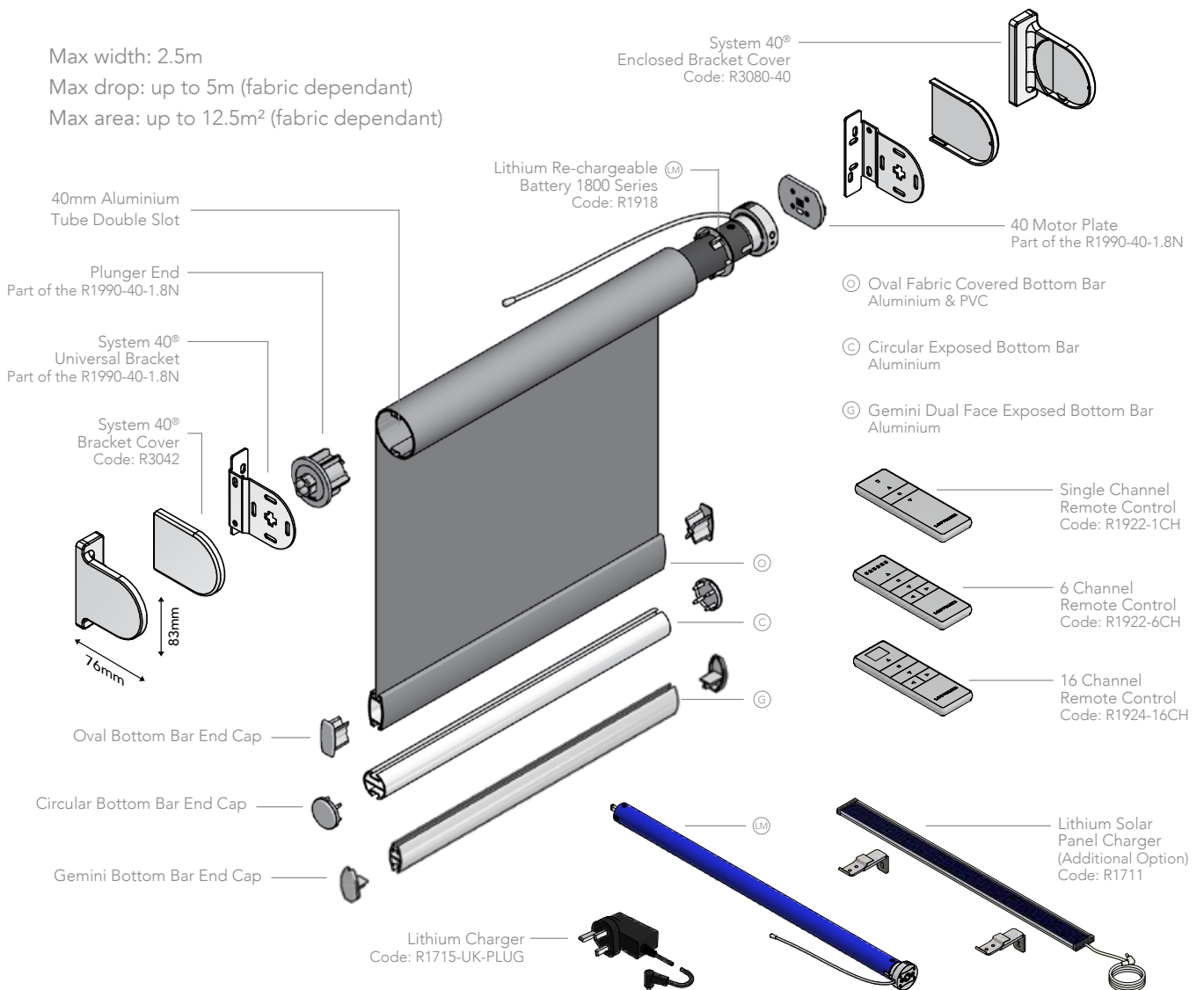

- Operate blinds effortlessly and economically with the Louvolite One Touch[®] Lithium re-chargeable 1800 Series Motor.
- Improved soft start and soft stop motor reduces sound levels.
- Manufactured using high quality engineering grade polymer.
- Easy and quick installation, no wiring needed.
- Child safe by design. Set up to four limits to stop blind at your chosen height.
- Conveniently operate multiple blinds from anywhere in the room with the single channel remote, 6 channel remote or 16 channel remote.
- Can be operated with the Louvolite Smart Home Hub (R1764-UK). Using wifi any One Touch blinds can be operated either through the Louvolite app on a phone or tablet anywhere in the world or by voice command with Amazon Echo, and Google Home.
- Motor weight capacity of 6kg.
- Charge the Lithium motor with a 8.4v charger (4m cable) or with a solar panel charger (1.4m cable) which trickle charges the motor from daylight.
- Colours available: 40mm motor set: white, beige, black and anthracite grey.

HARDWARE SPECIFICATION

Motorised Roller System

Our motorised roller blinds are manufactured using the specifically designed grooved aluminium tubing. The specified fabrics are formed and held into the tube with locking tape.

The brackets are made from mild steel, zinc plated and powder coated, suitable for top, face or side fixing.

A sprung plunger end mechanism is positioned at the opposite end to the motor plate, providing a more secure fit of the blind.

Performance

To ensure a positive performance, all Louvolite components are designed and manufactured in the UK using prime quality plastic materials.

10 year life cycle testing is done to ensure long lasting performance.

Operation

Using motorised operation, all blinds must be compliant with the child safety elements of BS EN13120.

Bottom Bar

Oval, made of aluminium or pvc, can be single or double wrapped in fabric or left exposed, while circular and the dual face Gemini, made of aluminium, only have the fabric formed and locked into the top part to leave the bar exposed. All fabric is formed and held into place with locking tape. The dual face Gemini bar, smooth on one side and angular on the other, improves the ease of manufacture and use of thicker laminate fabrics.

Maintenance

All of the roller blind system components are manufactured using aluminium, treated steel and plastic. They do not present any corrosion problems in normal environments. The system has been designed for a smooth operation, together with a rigidity to prolong the window blind's working life. Manufacturing size restrictions are included in this specification brochure.

ADDITIONAL OPTIONS - CASSETTES

System 32/40® Open Cassette
- 40mm fascia depth. Code: RM2106
white, beige, black, satin, chrome, bronze & anthracite grey

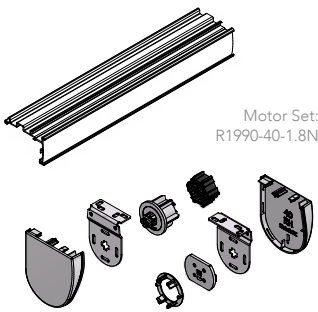

Motor Set:
R1990-40-1.8N

Bracket Covers: RM2137
white, beige, black, satin, chrome, bronze, grey & anthracite grey

System 32/40® Full Fascia Cassette
- 70mm fascia depth. Code: RM2108
white, black & anthracite grey

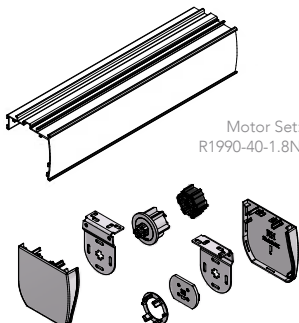

Motor Set:
R1990-40-1.8N

Bracket Covers: RM2139
white, black & anthracite grey

System 32/40® Hybrid Closed Cassette.
Fixing extrusion code: R3360
Curved profile code: R3362
white, black & anthracite grey

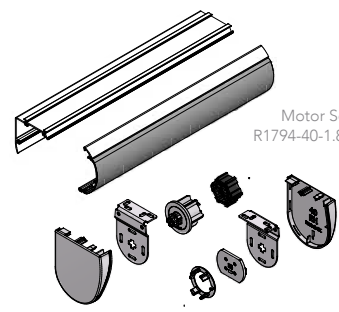

Motor Set:
R1794-40-1.8N

SYSTEMS MAX BLIND SIZE

LITHIUM 1800 SERIES

	FABRIC GROUP	BLIND WIDTH (m) FOR BLIND DROP (m) (Max deflection 6mm)					PARAMETERS		FEATURES	
		0.5	1.0	1.5	2.0	2.5	Rated Torque	1.8Nm	Min Blind Width	610
40®	up to 200g/m sq	5.0	5.0	5.0	5.0	5.0	Rated RPM	25rpm	Motor Weight Capacity	6kgs
	200 > 320g/m sq	3.75	3.75	3.75	3.75	3.75	Motor Diameter	28mm		
	320 > 485g/m sq	5.0	5.0	5.0	3.55	2.7	Rated Voltage	DC7.4V	Rated Power	6.7W
							Rated Current	3.0A	Power Source	Re-chargeable (plug-in charger or solar panel)
							IP Class	IP44		
							Inbuilt Receiver	Yes		

Your Louvolite Lithium Motorised Roller System Distributor:



www.louvolitecommercial.com

CI/SIB 1976 reference by SIB Agency		
(76.7)	X	